

# PRODUCT BRIEF



## TIBIT MICROPLUG

VIRTUALIZING NETWORKS

# TIBIT 10G SFP+ ONU

### FEATURES

- 10G OPTICAL TRANSCEIVER WITH EMBEDDED UNIVERSAL ETHERNET-TO-PON MAC BRIDGE
- AUTOSENSING EPON OR NG-PON2 PROTOCOLS
- HOT-PLUGGABLE SFP+ FOOTPRINT
- SUPPORTS SYMMETRIC 10G/10G MODE OF OPERATION
- COMPLIANT WITH ITU-T G.989 SPECIFICATIONS (NG-PON2 MODE)
- IN EPON MODE:
  - COMPLIANT WITH IEEE802.3AV, SIEPON AND DPOE SPECIFICATIONS
  - IEEE AES AND CTC TRIPLE-CHURNING SECURITY
- IN-BAND MANAGEMENT VIA ETHERNET OAM
- IEEE1588 TRANSPORT
- CLASS N1/N2 XGS OR PR20+/PRX30 OPTICS:
  - 1270NM DFB LASER (10G)
  - 1577NM APD/TIA BURST RECEIVER (10G)
- INTEGRATED DIGITAL DIAGNOSTICS AND MONITORING (SFF-8472)
- SINGLE FIBER SC RECEPTACLE
- MULTI-RATE LOCAL INTERFACE:
  - SFI (10G)
  - 1000BASE-X (1.25G)
- ENHANCED JITTER PERFORMANCE
- LOW POWER
- COMMERCIAL AND INDUSTRIAL TEMPERATURE

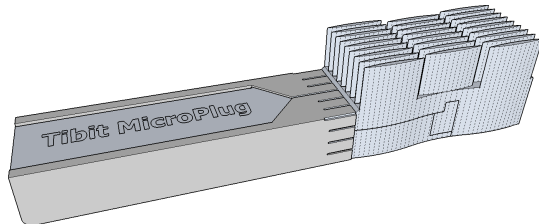

### OVERVIEW

TIBIT'S UNIVERSAL 10G ONU MICROPLUG IS AN AUTOSENSING NG-PON2 OR EPON HOT-PLUGGABLE SFP+ OPTICAL TRANSCEIVER WITH A BUILT-IN 10G ETHERNET-TO-PON MAC BRIDGE. IT USES 10G XGS/EPON OPTICS TO ENABLE EITHER THE NG-PON2 OR EPON SOLUTION AT A FRACTION OF THE COST OF TUNABLE DWDM OPTICS.

THIS 10G ONU PLUGS INTO LOW-COST ETHERNET SWITCHES OR OTHER ETHERNET-ENABLED NETWORKING EQUIPMENT WITH SFP OR SFP+ SOCKETS INSTANTANEOUSLY ENABLING THEM TO BE PART OF ANY 10G PON NETWORK.

THE SFP+ ONU MICROPLUG IS IDEALLY SUITED FOR SOFTWARE DEFINED NETWORKING (SDN) AND NETWORK FUNCTION VIRTUALIZATION (NFV) WITH ITS IN-BAND ETHERNET OAM CAPABILITY.

THE SFP+ ONU MICROPLUG ALLOWS AN OPERATOR TO CREATE AN OLT SOLUTION AT REMOTE LOCATIONS WITHOUT ENVIRONMENTALLY CONTROLLED CABINETS.

ALSO, IT'S UNIQUE ABILITY TO AUTONSENSE AND AUTO-CONFIGURE ITSELF TO OPERATE IN EITHER NG-PON2 OR 10G EPON NETWORK SIGNIFICANTLY LOWERS CAPEX/OPEX COSTS.

THE TIBIT MICROPLUG ENABLES SERVICE PROVIDERS TO QUICKLY DEPLOY HIGH-BANDWIDTH SERVICES IN AN AGILE, ELASTIC, AND DYNAMIC WAY.

THE TECHNOLOGY REQUIRES LESS SPACE AND POWER THAN ANY OTHER PRODUCT ON THE MARKET.

### APPLICATIONS

- PON ONU CONNECTIVITY FOR CPE DEVICES
- OUTSIDE PLANT PON ACCESS BRIDGE CONNECTIVITY
- CABLE MSO CCAP PON CONNECTIVITY
- REMOTE DOCSIS PHY
- WIRELESS BACKHAUL
- HIGH-BANDWIDTH BUSINESS PON CONNECTIVITY
- MDU-LOCATED PON BRIDGE
- HIGH-DENSITY PON AGGREGATION
- DATA CENTER PON

## TIBIT COMMUNICATIONS, INC.

1 WILLOWBROOK COURT, SUITE 150  
PETALUMA, CA 94954  
PHONE: 707-486-6170

[WWW.TIBITCOMMUNICATIONS.COM](http://WWW.TIBITCOMMUNICATIONS.COM)

Part Number	Link Budget	Case Temp
TPUN-33N201 1S-5CA0	Class N2/PR30	0..70C
TPUN-33N101 1S-5IA0	Class N1/PR20+	-40..85C